

# Sunrise Internet Box



Sunrise

Lieferumfang / Fourniture / Volume di consegna / Scope of delivery

Details, siehe Handbuch (support.sunrise.ch) / Détails, voir manuel (support.sunrise.ch)  
 Dettagli, vedi manuale (support.sunrise.ch) / For details, refer to User Manual (support.sunrise.ch)

**1 Sunrise Internet Box**

DSL/Fiber connected	DECT DECT phone connected
Internet connected	Phone number ok
Configuring - don't touch	Second phone number ok
TV service configured	WLAN 2.4 GHz
USB device connected	WLAN 5 GHz

**In separatem Umschlag / Dans une enveloppe séparée / Nella busta a parte / In a separate envelope**

Falls Glasfaser  
 Avec fibre optique  
 In caso di fibra ottica  
 In Case of fiber

**Wichtig für Neukunden! Important pour les nouveaux clients! Importante per i nuovi clienti! Important for new customers!**

Bitte starten Sie die Installation erst nach Erhalt der Sunrise Aktivierungsbestätigung (E-Mail oder SMS).

Nous vous prions de bien vouloir lancer l'installation seulement après réception de la confirmation d'activation par Sunrise (e-mail ou SMS).

La preghiamo d'iniziare con l'installazione soltanto dopo aver ricevuto la conferma dell'attivazione dalla Sunrise (e-mail o SMS).

Please start installation only after receiving the activation confirmation by Sunrise (e-mail or SMS).

## Installation Internet / Installation Internet / Installazione Internet / Internet installation

**1**

anschalten / démarrer / accendere / turn on

**2 min**

Synchronisation / Démarrage / Avviare / Booting

---

**2**

**DSL**

optional / optionnel / opzionale / optional

**Glasfaser / Fibre / Fibra ottica / Fiber**

oder / ou / o / or

Falls Glasfaser / Avec fibre optique / In caso di fibra ottica / In Case of fiber

---

**3**

10-15 min

**Automatische Konfiguration**  
 Configuration automatique  
 Configurazione automatica  
 Automatic configuration

**Betriebsbereit**  
 Prêt à l'emploi  
 Operativa  
 Operable

**LEDs dimmen**  
 Adapter la luminosité des LED  
 Adattare la luminosità dei LED  
 Dim LEDs

**Mehr LED Infos**  
 Plus d'infos LED  
 Maggiori informazioni sui LED  
 More LED info

## Phone & Internet

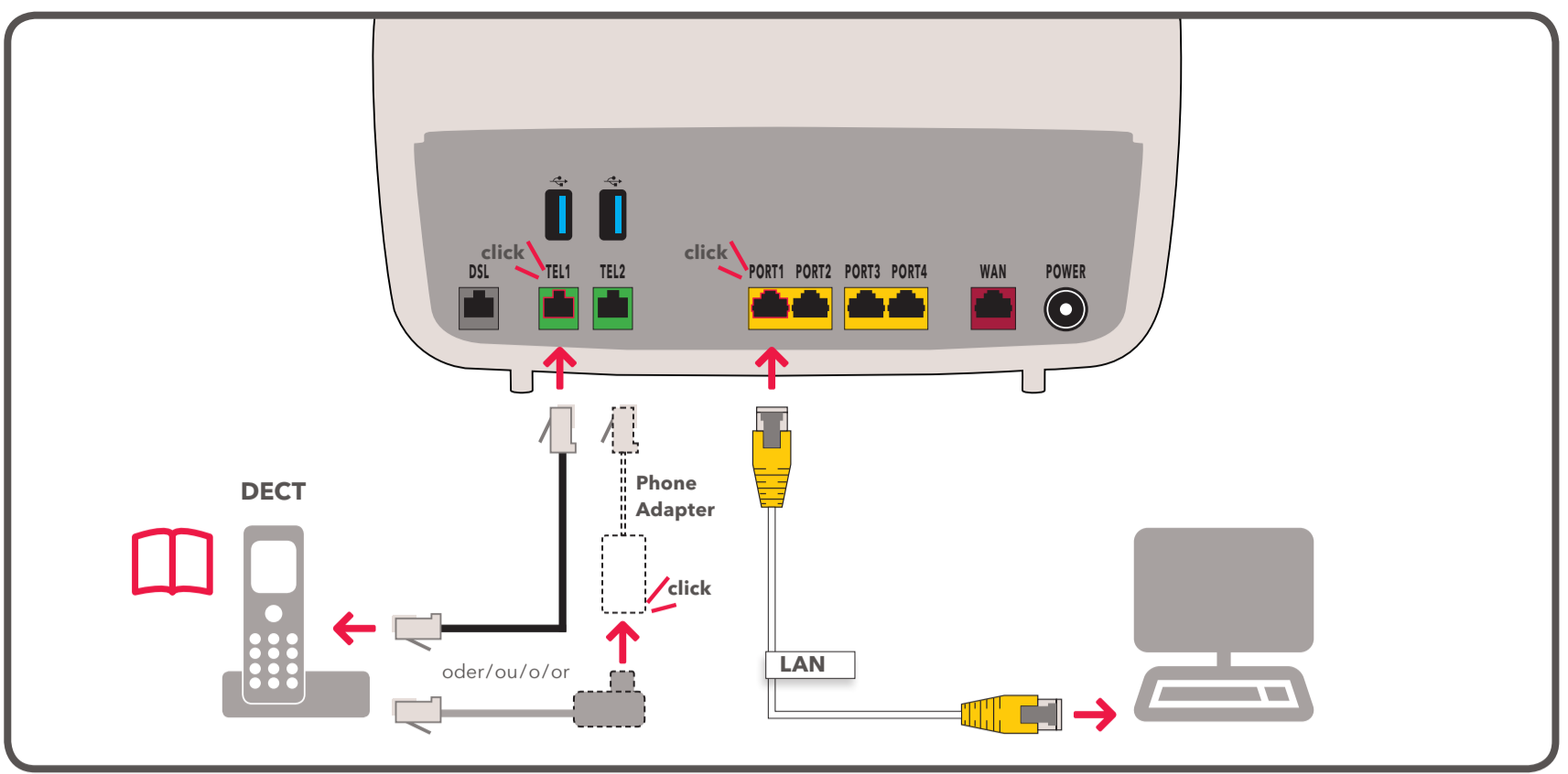

## WiFi & Admin Login

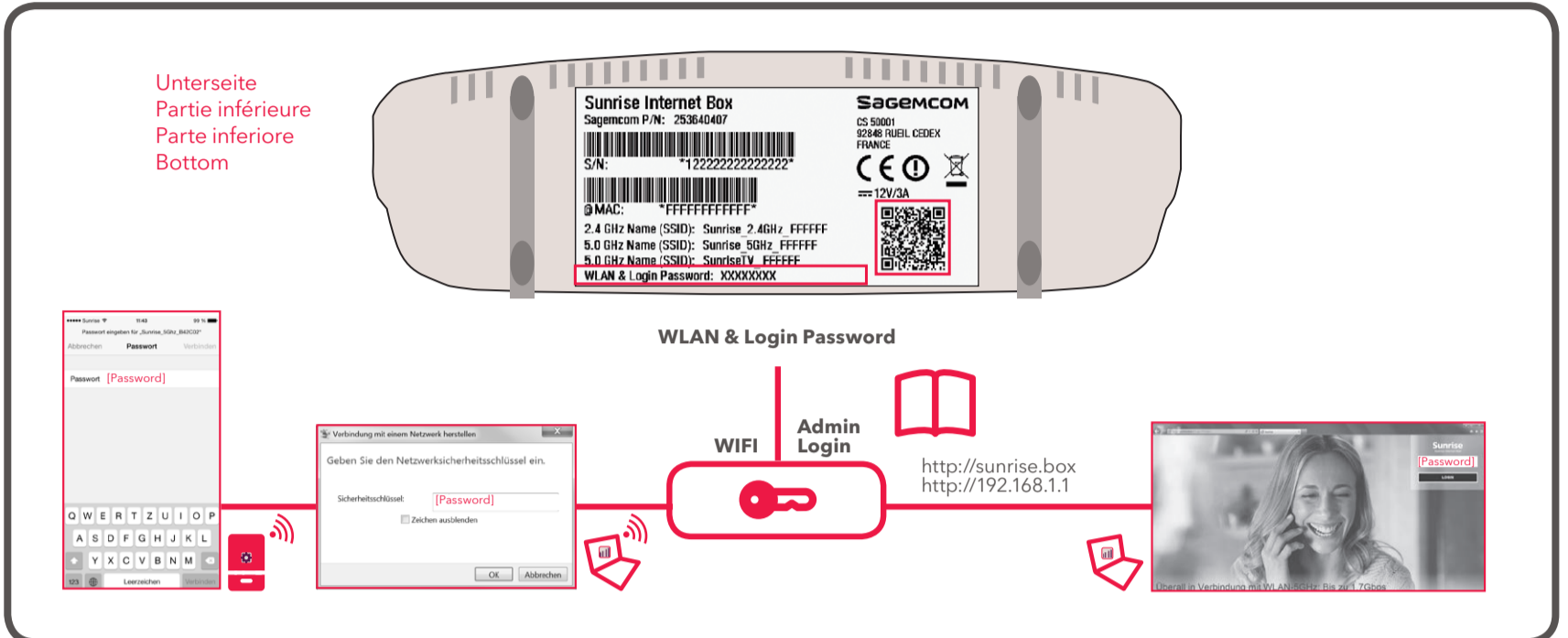

## Sunrise Smart TV

Lieferumfang/ Fourniture/ Volume di consegna/ Scope of delivery

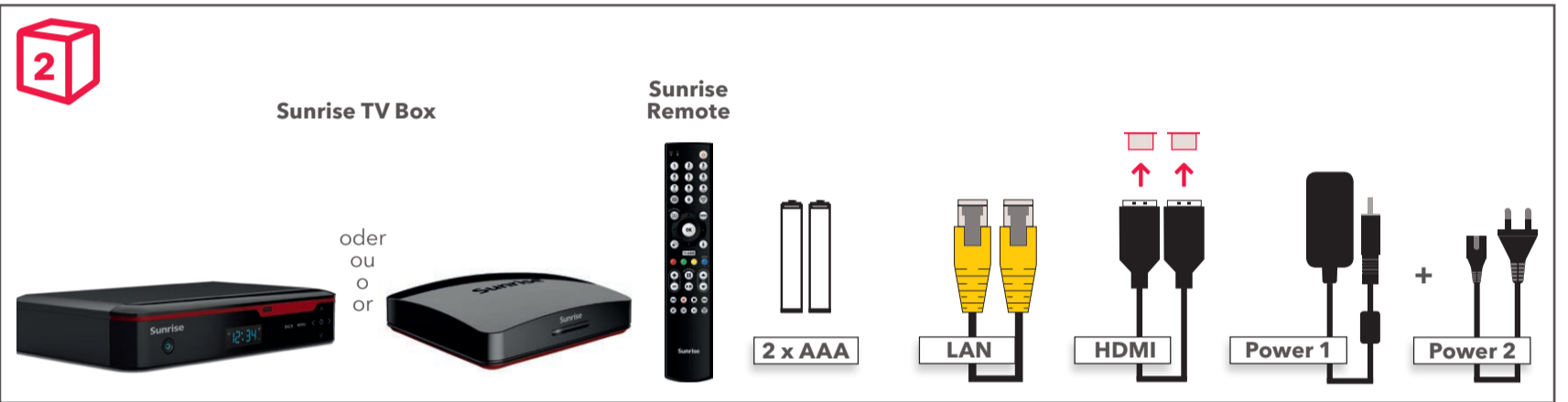

support.sunrise.ch

## Installation Sunrise TV/ Installation Sunrise TV/ Installazione Sunrise TV/ Sunrise TV installation

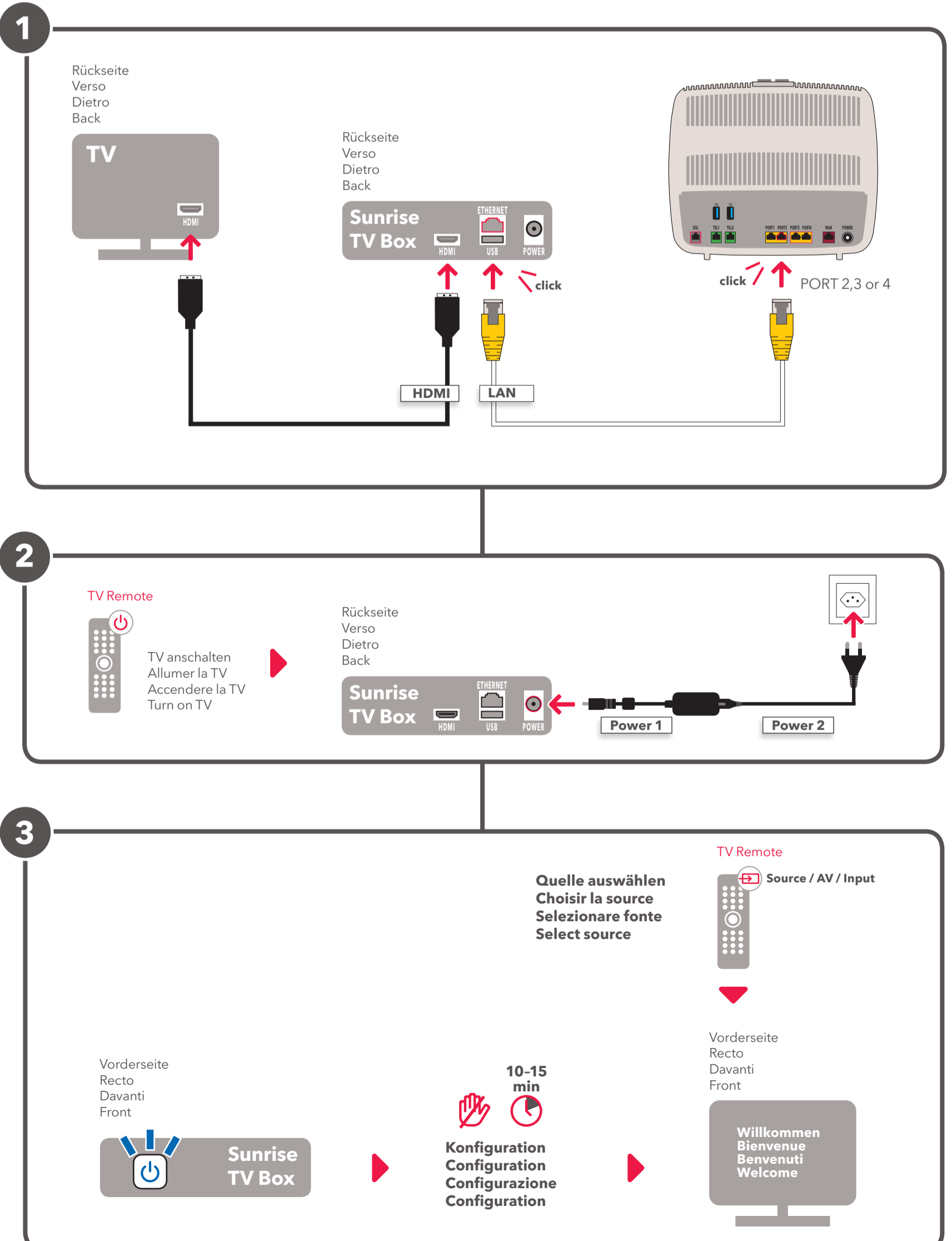

Im Fehlerfall ab Abschnitt 3 wiederholen/ En cas d'erreur, répéter à partir de la section 3/ In caso di errore, ripetere dal paragrafo 3/ In case of error, repeat steps from section 3



0253719187